

# **MACHINE PARTS CHART** **for** **SINGER\***

**300U103**

\* A Trademark of THE SINGER COMPANY  
Copyright © 1984 THE SINGER COMPANY  
All Rights Reserved Throughout The World

300U103





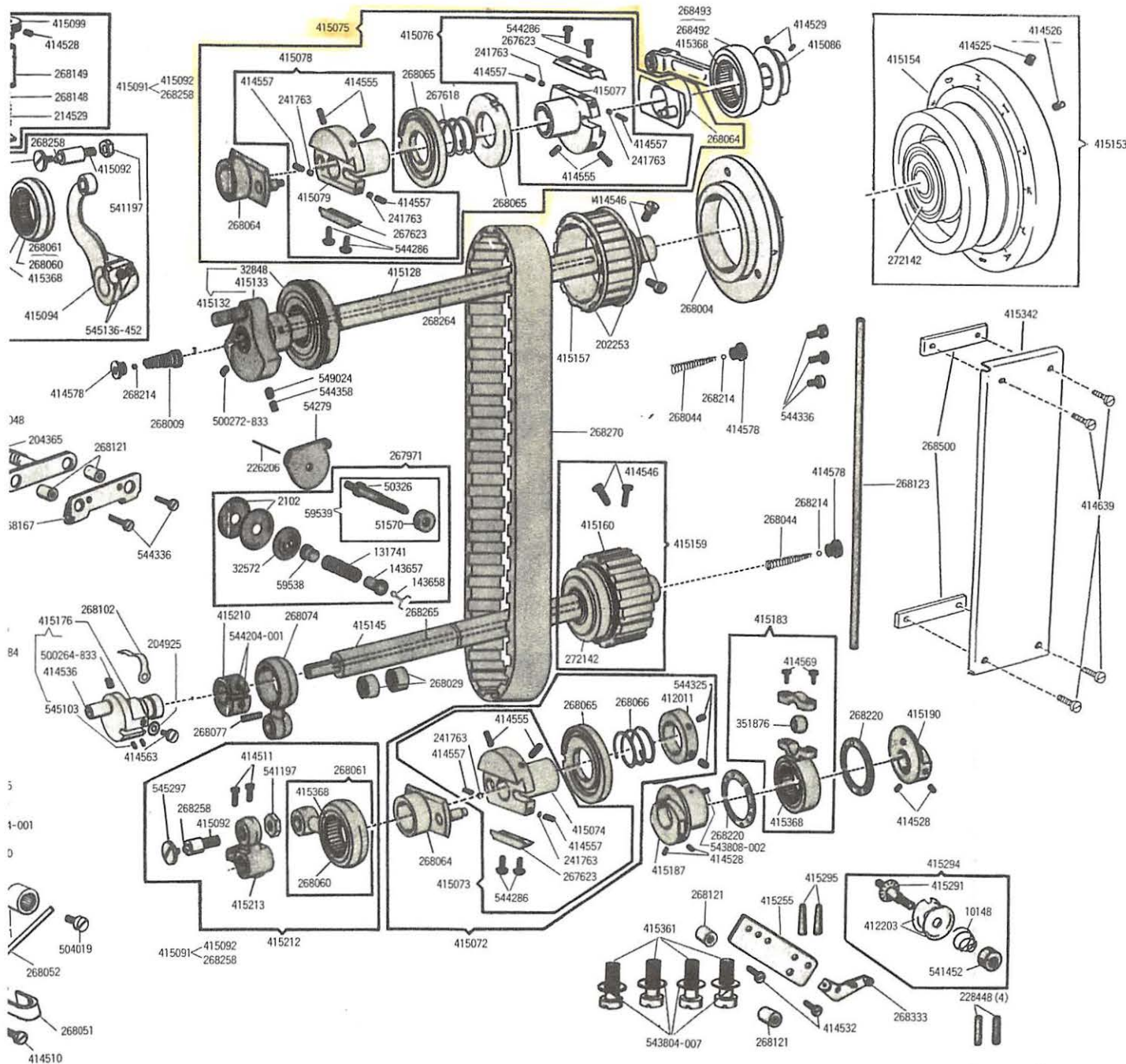

## PART NO.

## DESCRIPTION

229	Loop Deflector Screw (2)
2102	Needle Thread Tension Disc (2)
10148	Looper Thread Tension Spring
32572	Needle Thread Tension Releasing Disc
32788	Lifting Rock Shaft Crank with 141424
32789	Lifting Rock Shaft 267633 with 32788 and 548035
32825	Spreader Driving Rock Shaft Screw Stud Oil Packing (wick)
32827	Throat Plate
32848	Arm Shaft Ball Bearing (front)
50169	Looper Thread Guide (top of Arm) Bracket Screw (2)
50326	Needle Thread Tension Stud
51570	Needle Thread Tension Thumb Nut
54279	Needle Thread Tension Thread Guide (double)
59538	Needle Thread Tension Spring Bushing (back)
59539	Needle Thread Tension Stud 50326 with 51570
131741	Needle Thread Tension Spring
141424	Lifting Link Hinge Pin Set Screw (2)
141478	Needle Guard Set Screw (back)
141338	Lifting Crank Set Screw
141494	Needle Guard Set Screw (front)
143657	Needle Thread Tension Spring Bushing (front)
143658	Needle Thread Tension Thumb Nut Locking Spring
201363	Foot Lifter Lever Hinge Screw
201477	Looper Throw-out Gear Locking Plunger Screw Bushing
202253	Arm Shaft Connection Belt Pulley Spring Flange (2)
202330	Needle Bar Connecting Stud Oil Packing (wick)
203941	Foot Lifter Lever (front) Spring
204348	Foot Lifter Lever Spring
204365	Needle Thread Tension Releaser Spring
204925	Looper Driving Crank Oil Hole Cover Screw Washer
214529	Needle Bar Rock Frame Regulating Pin Spring
226206	Needle Thread Tension Releasing Pin
228448	Machine Locating Stud (4)
236957	Thread Lubricator Oil Pad (felt) (3)
240245	Feed Regulating Stud Retaining Spring
241763	Feed Driving Eccentric Friction Plate Screw Set Screw Packing (brass) (2)
241763	Lifting Eccentric Friction Plate Screw Set Screw Packing (brass) (2)
241763	Needle Bar Rock Frame Driving Eccentric Friction Plate Screw Set Screw Packing (brass) (2)
244071	Lifting Eccentric Connection Hinge Pin Oil Packing (wick)
244071	Lifting Link Hinge Pin Oil Packing (wick) (2)
244084	Presser Bar Spring Housing Set Screw Packing (fiber)
248423	Foot Lifter Rod Cotter Pin
250265	Looper Throw-out Gear Locking Plunger Spring
267093	Lifting Lever Needle Bearing (2)
267110	Lifting Rock Shaft Needle Bearing (2)
267604	Arm Side Cover
267612	Foot Lifter Crank
267613	Foot Lifter Lever (front) with 267614
267614	Foot Lifter Lever (front) Hinge Pin
267615	Foot Lifter Lever Rod with 248423
267617	Lifting Eccentric Connection Hinge Pin with 244071
267617	Lifting Link Hinge Pin with 244071 (2)
267618	Lifting Eccentric Adjusting Disc Spring
267623	Feed Driving Eccentric Friction Plate
267623	Needle Bar Rock Frame Driving Eccentric Friction Plate
267623	Lifting Eccentric Friction Plate
267626	Lifting Lever Hinge Stud
267627	Lifting Link
267628	Lifting Presser Bar
267631	Lifting Presser Bar Lifting Crank with 268258
267632	Lifting Presser Foot with 414638
267763	Lifting Rock Shaft
267641	Presser Bar Spring
267645	Presser Bar Spring Arm Fork Lock Washer (nylon)
267646	Presser Bar Spring Arm Fulcrum
267650	Presser Bar Pressure Cylinder Support Retainer
267653	Presser Bar Spring Plunger Bearing Bushing (Oil Retaining)

# NUMERICAL LIST OF PARTS 300U103 MACHINE

PART NO.	DESCRIPTION	PART NO.	DESCRIPTION
267655	Presser Bar Spring Plunger Washer (leather)	268208	Looper Carrier Crank Hinge Pin with 268258
267656	Thread Lubricator with three 236957	268214	Arm Shaft Oil Stop Ball 5/32 in. diam. (2)
267657	Vibrating Presser Bar	268214	Bed Shaft Oil Stop Ball 5/32 in. diam.
267658	Vibrating Presser Bar Hinge Stud	268216	Looper Driving Connection 268098 with 268099
267659	Vibrating Presser Foot with 414638	268219	Needle Bar Rock Frame Thread Guide
267664	Feed Dog, 40 needle hole, with 267665, and two 229	268220	Spreader Driving Eccentric Thrust Washer (2)
267665	Loop Deflector	268258	Feed Driving Connection Hinge Stud Oil Packing (wick)
267718	Presser Bar Spring Arm Ball Bearing Retainer	268258	Feed Lifting Connection Hinge Stud Oil Packing (wick)
267738	Presser Bar Spring Arm	268258	Feed Lifting Link Hinge Pin Oil Packing (wick) (2)
267907	Lifting Presser Bar Guide Rod	268258	Lifting Presser Bar Lifting Crank Oil Packing (wick)
267933	Feed Lifting Rock Shaft	268258	Looper Carrier Crank Hinge Pin Oil Packing (wick)
267970	Bed Plate Slide Spring (left upper)	268258	Needle Bar Rock Frame Driving Connection Hinge Stud
267971	Needle Thread Tension complete, Nos. 32572, 59538, 59539, 131741, 143657, 143658 and two 2102		Oil Packing (wick)
268004	Arm Shaft Ball Bearing (back) Housing	268264	Arm Shaft Oil Control Rod (wood)
268009	Arm Shaft Oil Stop Ball Spring (front)	268265	Bed Shaft Oil Control Rod (wood)
268022	Bed Plate Slide Spring (2)	268270	Arm Shaft Connection Belt (reinforced neoprene)
268029	Bed Shaft Needle Bearing (2)	268278	Needle Bar Oiling Felt Holder (2)
268029	Needle Bar Rock Frame Needle Bearing (2)	268310	Needle Guard
268032	Face Plate Lock Spring	268312	Needle Thread Guide (on Arm Head)
268033	Face Plate Lock Stud	268313	Looper throw-out Gear Locking Plunger Handle
268035	Feed Bar Hinge Pin	268330	Face Plate Hinge Stud (2)
268044	Arm Shaft Oil Stop Ball Spring (rear)	268333	Looper Thread Tension Thread Guide
268044	Bed Shaft Oil Stop Ball Spring	268367	Looper Carrier
268051	Looper Thread Guide	268368	Looper Carrier 268367 with two 268099
268052	Looper Thread Take-up Rod	268373	Looper Thread Guide (on bed at looper) for all gauges from 3/16 to 2 inches
268055	Needle Bar Connecting Link with two 270266		Looper with 141478 and 141494
268060	Feed Driving Connection	268380	Looper and Needle Guard complete, Nos. 268310 and 268380
268060	Needle Bar Rock Frame Driving Connection	268382	
268061	Feed Driving Connection 268060 with 415368	268492	Lifting Eccentric Connection
268061	Needle Bar Rock Frame Driving Connection 268060 with 415368	268493	Lifting Eccentric Connection 268492 with 415368
		268499	Spreader Bar
268064	Feed Driving Eccentric	268500	Looper Thread Guide Gasket (2)
268064	Needle Bar Rock Frame Driving Eccentric	268505	Looper Thread Guide (top of Arm)
268064	Lifting Eccentric	268506	Looper Thread Guide (top of Arm) Bracket 268111 with 268505 and two 50169
268065	Feed Driving Eccentric Adjusting Disc	268512	Needle Thread Guide (on Needle Bar Connecting Stud)
268065	Lifting Eccentric Adjusting Disc	268513	Needle Thread Guide (on side of Arm) (2)
268065	Needle Bar Rock Frame Driving Eccentric Adjusting Disc	268602	Looper Holder with two 414558
268066	Feed Driving Eccentric Adjusting Disc Spring	268638	Spreader with 268162
268070	Feed Driving Rock Shaft	270026	Feed Regulating Stud Spring
268071	Feed Driving Rock Shaft Needle Bearing (2)	270266	Needle Bar Connecting Link Needle Bearing (2)
268071	Feed Lifting Rock Shaft Needle Bearing (2)	272142	Arm Shaft Ball Bearing (back)
268071	Spreader Driving Rock Shaft Needle Bearing (2)	272142	Bed Shaft Ball Bearing
268074	Feed Lifting Connection	276025	Presser Bar Spring Arm Ball Bearing
268077	Feed Lifting Eccentric Lubricating Pad (wood)	350604	Presser Bar Spring Arm Fulcrum Set Screw (2)
268078	Feed Lifting Link	351876	Spreader Driving Rock Shaft Screw Stud Ball Roller
268079	Feed Lifting Link Hinge Pin with 268258 (2)	412011	Feed Driving Eccentric Adjusting Disc Spring Collar with two 544325
268081	Feed Regulating Stud		
268082	Feed Regulating Stud Socket	412203	Looper Thread Tension Disc (2)
268093	Looper Carrier Shaft	414501	Feed Lifting Crank Pinch Screw
268096	Looper Carrier Shaft Bushing (left) Position Plate	414504	Arm Head Screw (3)
268098	Looper Driving Connection	414504	Lifting Rock Shaft Bracket Screw (2)
268099	Looper Driving Connection Needle Bearing	414508	Bed Plate Screw (8)
268099	Looper Carrier Needle Bearing (2)	414509	Foot Lifter Arm Pinch Screw
268102	Looper Driving Crank Oil Hole Cover	414509	Lifting Eccentric Connection Crank Pinch Screw (2)
268111	Looper Thread Guide (top of Arm) Bracket	414510	Looper Thread Guide Screw
268121	Looper Thread Tension Bracket Spacing Collar (2)	414511	Feed Driving Rock Shaft Crank Pinch Screw (2)
268121	Needle Thread Tension Bracket Spacing Collar (2)	414511	Feed Lifting Rock Shaft Crank Pinch Screw (2)
268123	Looper Thread Tube	414511	Lifting Crank Pinch Screw (2)
268131	Looper Throw-out Safety Latch	414511	Needle Bar Connecting Stud Pinch Screw (2)
268132	Looper Throw-out Safety Latch Spring	414512	Lifting Presser Bar Guide Block Pinch Screw
268133	Looper Throw-out Safety Latch Spring Bracket	414514	Needle Thread Guide Screw (2)
268139	Needle Bar Connecting Link Cap Washer	414515	Looper Carrier Shaft Bushing (left) Position Plate Screw (2)
268144	Needle Bar Oiling Felt (2)	414516	Looper Carrier Crank Hinge Pin Pinch Screw
268148	Needle Bar Rock Frame Regulating Stud	414516	Lifting Presser Bar Guide Block Adjusting Screw
268149	Needle Bar Rock Frame Regulating Stud Sleeve	414517	Needle Bar Connecting Link Cap Washer Screw
268162	Spreader Point	414518	Feed Dog Screw (2)
268167	Needle Thread Tension Bracket	414518	Throat Plate Screw (3)
268171	Needle Thread Tension Releasing Plate (adjustable)	414519	Needle Set Screw
268184	Spreader Bar Bracket	414520	Feed Dog Shank Screw
268190	Spreader Driving Pin	414524	Spreader Bar Bracket Screw (2)



# NUMERICAL LIST OF PARTS 300U103 MACHINE

PART NO.	DESCRIPTION	PART NO.	DESCRIPTION
414525	Machine Pulley Set Screw	415061	Lifting Crank with 141424, 141338 and two 414511
414526	Machine Pulley Position Screw	415065	Feed Driving Rock Shaft Collar with two 504020 (2)
414522	Needle Bar Oiling Felt Holder Screw (2)	415065	Feed Lifting Rock Shaft Collar with two 504020 (2)
414523	Presser Bar Spring Housing Oil Screw	415065	Lifting Rock Shaft Collar with two 504020
414527	Needle Bar Rock Frame Regulating Stud Sleeve Set Screw	415065	Spreader Driving Rock Shaft Collar with two 504020 (2)
414528	Spreader Driving Eccentric Counterbalance Set Screw (2)	415067	Lifting Lever with two 267093
414528	Spreader Driving Eccentric Set Screw (2)	415069	Lifting Eccentric Connection Crank with 414543 and two 414509
414528	Looper Throw-out Gear Locking Plunger Stop Screw Set Screw	415071	Lifting Rock Shaft Bracket
414528	Needle Bar Rock Frame Regulating Stud Cap Set Screw	415072	Feed Driving Eccentric Complete, Nos. 268064, 268065, 268066, 412011 and 415073
414529	Lifter Eccentric Spacing Collar Set Screw (4)	415073	Feed Driving Flange 415074 with 267623 two each 241763, 414555, 414557 and 544286
414529	Spreader Holder Set Screw (2)	415073	Feed Driving Flange
414529	Feed Bar Hinge Pin Collar Set Screw	415074	Lifting Eccentric and Needle Bar Rock Frame Driving Eccentric complete, Nos. 267618, 415076, 415078 and two each 268064, 268065
414530	Lifting Presser Bar Guide Rod Set Screw (lower)	415075	Lifting Eccentric Flange 415077 with 267623, two each 241763, 414555, 414557 and 544286
414532	Looper Thread Tension Bracket Screw (2)	415075	Lifting Eccentric Frange
414534	Face Plate Lock Spring Screw (2)	415077	Needle Bar Rock Frame Driving Eccentric Flange 415079 with 267623, two each 241763, 414555, 414557 and 544286
414536	Looper Driving Crank Oil Stop Screw	415078	Needle Bar Rock Frame Driving Eccentric Frange
414537	Looper Thread Guide (top of arm) Bracket Screw (2)	415079	Lifting Eccentric Spacing Collar with two 414529
414539	Needle Bar Rock Frame Thread Guide Screw (2)	415086	Feed Driving Connection Hinge Stud 415092 with 268258
414545	Needle Thread Guide (on Needle Bar Connecting Stud) Set Screw	415091	Feed Lifting Connection Hinge Stud 415092 with 268258
414546	Arm Shaft Connection Belt Pulley Set Screw (2)	415091	Needle Bar Rock Frame Driving Connection Hinge Stud 415092 with 268258
414546	Bed Shaft Connection Belt Pulley Set Screw (2)	415091	Needle Bar Rock Frame Driving Connection Hinge Stud
414548	Presser Bar Spring Arm Ball Bearing Retainer	415092	Feed Driving Connection Hinge Stud
414543	Lifting Eccentric Connection Hinge Pin Pinch Screw	415092	Feed Lifting Connection Hinge Stud
414549	Feed Lifting Rock Shaft Crank Position Screw	415092	Needle Bar Rock Frame Driving Arm 415094 with 415091, 541197, 268061 and 545297
414552	Spreader Screw	415093	Needle Bar Rock Frame Driving Arm with two 545136-452
414553	Looper Holder Screw	415094	Needle Bar Rock Frame Regulating Stud complete, Nos. 214529, 415099, 268148 and 268149
414555	Feed Driving Falnge Set Screw (2)	415098	Needle Bar Rock Frame Regulating Stud Cap with 414528
414555	Lifting Eccentric Flange Set Screw (2)	415099	Foot Lifter Lever with 543850-001
414555	Needle Bar Rock Frame Driving Eccentric Flange Set Screw (2)	415104	Presser Bar Spring Housing complete, Nos. 415107, 267641, 415109, 415114, 415113, 415115, 267655 and 267645
414556	Looper Thread Guide (on bed at looper) Screw	415106	Presser Bar Spring Housing with 414523, 414579, 541198 and 548459
414557	Feed Driving Eccentric Friction Plate Screw Set Screw (2)	415107	Presser Bar Spring Plunger Bearing with 267653
414557	Lifting Eccentric Friction Plate Screw Set Screw (2)	415109	Presser Bar Spring Housing Support with 244084 and 544358
414557	Needle Bar Rock Frame Driving Eccentric Friction Plate Screw Set Screw (2)	415111	Presser Bar Spring Arm Fork
414558	Looper Set Screw	415113	Presser Bar Spring Plunger
414558	Looper Adjusting Screw	415114	Presser Bar Spring Plunger Cap
414559	Feed Dog Shank Adjusting Screw	415115	Foot Lifter Arm with 414509 and 545213
414563	Looper Driving Crank Oil Hole Cover Screw	415120	Arm Shaft with 268009, 268044, 268264, two each 268214 and 414578
414564	Looper Throw-out Gear Locking Plunger Stop Screw	415128	Needle Bar Crank 415133 with 32848
414566	Foot Lifter Crank Stop Screw Stud	415132	Needle Bar Crank with 500272-833, 544358 and 549024
414567	Presser Bar Spring Arm Hinge Screw	415133	Bed Shaft with 268044, 268214, 268265 and 414578
414569	Spreader Driving Connection Cap Screw (2)	415145	Machine Pulley 415154 with 272142
414570	Foot Lifter Lever Spring Screw Eye	415153	Machine Pulley (aluminum alloy casting) for "V" belt (outside diameter of belt groove 2.9 inches) with 414525 and 414526
414571	Foot Lever (front) Spring Screw Stud	415154	Arm Shaft Connection Belt Pulley with two each 414546 and 202253
414575	Spreader Driving Rock Shaft Screw Stud	415159	Bed Shaft Connection Belt Pulley 415160 with 272142
414577	Foot Lifter Lever Rod Hinge Screw	415160	Bed Shaft Connection Belt Pulley with two 414546
414578	Arm Shaft Oil Stop Ball Screw (2)	415167	Looper Carrier Shaft 268093 with 415168 and 415170
414578	Bed Shaft Oil Stop Ball Screw	415168	Looper Carrier Shaft Bushing (left) with 500264-833 and 549024
414579	Presser Bar Spring Housing Screw Stud	415170	Looper Carrier Shaft Bushing (right) with 500264-833 and 549024
414638	Lifting Presser Foot Pinch Screw	415174	Looper Carrier Crank with 414516
414638	Vibrating Presser Foot Pinch Screw		
414639	Looper Thread Tube Cover Screw (4)		
415014	Face Plate with 268033 and two 545174-452		
415016	Face Plate Lock Spring Plate		
415026	Bed Plate (left)		
415027	Bed Plate Slide 415028 complete Nos. 267970 with two 268022 and six 549146		
415028	Bed Plate Slide		
415034	Bed Plate (right) 415035 with 240245, 268081, 268082, 270026 and two 545249-452		
416035	Bed Plate (right)		
415040	Needle Bar with 414519		
415041	Needle Bar		
415044	Needle Bar Rock Frame 415045 with 267657, 415040 and two each 414522, 268144 and 268278		
415045	Needle Bar Rock Frame		
415053	Needle Bar Connecting Stud with 202330, 414545 and two 414511		
415059	Lifting Presser Bar Guide Block with 414512 and 414516		

# NUMERICAL LIST OF PARTS 300U103 MACHINE

PART NO.	DESCRIPTION	PART NO.	DESCRIPTION
415176	Looper Driving Crank with 414536, 500264-833 and two 545103	543850-001	Needle Thread Tension Releasing Plate Pin
415178	Looper Throw-out Rack Rod 415179 with 541451	544204-001	Feed Lifting Eccentric Set Screw (2)
415179	Looper Throw-out Rack Rod	544204-001	Feed Bar Set Screw (2)
415180	Looper Throw-out Gear with two 500264-833	544204-001	Spreader Driving Crank Set Screw (2)
415182	Looper Throw-out Gear Looking Plunger	544286	Feed Driving Eccentric Friction Plate Screw (2)
415183	Spreader Driving Connection with 415368, 351876 and two 414569	544286	Lifting Eccentric Friction Plate Screw (2)
415187	Spreader Driving Eccentric and 543808-002 with two 414528	544286	Needle Bar Rock Frame Driving Eccentric Friction Plate Screw (2)
415190	Spreader Driving Eccentric Counterbalance with two 414528	544301	Lifting Presser Bar Guide Rod Set Screw (upper)
415192	Spreader Driving Rock Shaft with 504019	544322	Lifting Lever Hinge Stud Set Screw (2)
415194	Spreader Driving Crank with two 544204-001	544325	Feed Driving Eccentric Adjusting Disc Spring Collar Set Screw (2)
415196	Spreader Holder with two 414529	544336	Arm Shaft Ball Bearing (back) Housing Screw (3)
415198	Feed Bar with 545213 and two 544204-001	544336	Needle Thread Tension Bracket Screw (2)
415200	Feed Driving Rock Frame with 500264-833 and 549024	544336	Foot Lifter Lever (back) Spring Screw
415202	Feed Bar Hinge Pin Collar with 414529	544358	Needle Bar Crank Position Screw Check Screw
415204	Feed Lifting Crank with 414501 and 545213	544358	Presser Bar Spring Housing Set Screw
415206	Feed Lifting Rock Shaft Crank with 414549 and two 414511	544875	Arm Plug (2)
415208	Feed Dog Shank with 414559 and 541200	545103	Looper Driving Crank Position Screw (2)
415210	Feed Lifting Eccentric with 268077 and two 544204-001	545136-452	Needle Bar Rock Frame Driving Arm Pinch Screw (2)
415212	Feed Driving Rock Shaft Crank 415213 with 268061, 415091, 541197 and 545297	545174-452	Face Plate Hinge Stud Set Screw (2)
415213	Feed Driving Rock Shaft Crank with two 414511	545205-451	Looper Throw-out Safety Latch Spring Bracket Screw (2)
415252	Needle Thread Tension Releaser Cap with 504048	545205-451	Presser Bar Pressure Cylinder Support Retainer Screw (2)
415255	Looper Thread Tension Bracket	545213	Feed Lifting Link Hinge Pin Set Screw (2)
415291	Looper Thread Tension Stud	545213	Foot Lifter Arm Set Screw
415292	Looper Carrier Crank Clamping Stud	545213	Spreader Driving Crank Position Screw
415293	Spreader Driving Rock Shaft Screw Stud 414575 with 32825	545249-452	Arm Side Cover Screw (4)
415294	Looper Thread Tension Complete Nos. 10148, 415291, 541452 and two 412203	545249-452	Feed Regulating Stud Socket Screw (2)
415295	Arm Position Pin (2)	545405	Presser Bar Spring Arm Hinge Screw Nut
415308	Lifting Eccentric Spacing Collar with two 414529	545424	Spreader Driving Rock Shaft Screw Stud Nut
415342	Looper Thread Tube Cover	545297	Feed Driving Connection Cap Screw
415357	Needle Thread Tension Releaser	545297	Needle Bar Rock Frame Driving Connection Cap Screw
415361	Arm Screw (4)	545489	Feed Dog Shank Screw Lock Nut
415368	Lifting Eccentric Connection Needle Bearing	547670	Spreader Screw Washer
415368	Feed Driving Connection Needle Bearing	548005	Arm Head Position Pin
415368	Needle Bar Rock Frame Driving Connection Needle Bearing	548035	Lifting Rock Shaft Crank Pin
415368	Spreader Driving Connection Needle Bearing	548154	Presser Bar Spring Arm Hinge Screw Washer
500264-833	Looper Carrier Shaft Bushing Set Screw (2)	548459	Presser Bar Spring Housing Screw Stud Nut Lock Washer
500264-833	Looper Driving Crank Set Screw	548459	Looper Carrier Crank Clamping Stud Washer
500264-833	Looper Throw-out Gear Set Screw (2)	549024	Feed Driving Rock Frame Position Screw
500264-833	Feed Driving Rock Frame Set Screw	549024	Looper Carrier Shaft Bushing Position Screw (2)
500272-833	Needle Bar Crank Set Screw	549024	Needle Bar Crank Position Screw
502986	Arm Head Plug	549146	Bed Plate Slide Spring Screw (6)
504019	Looper Thread Take-up Rod Set Screw	Cat. 4112	Needle #23
504019	Thread Lubricator Screw		<b>ACCESSORIES</b>
504020	Feed Driving Rock Shaft Collar Set Screw (4)	21887	Wrench
504020	Feed Lifting Rock Shaft Collar Set Screw (4)	41400	Machine Rest Pin (wood)
504020	Lifting Rock Shaft Collar Set Screw (2)	167448	Machine Base Oil Drain Jar
504020	Spreader Driving Rock Shaft Collar Set Screw (4)	202784	Foot Lifter Treadle Chain Hook (2)
504048	Needle Thread Tension Releaser Cap Set Screw	228444	Machine Cushion (neoprene) (4)
541166-003	Foot Lifter Lever Rod Hinge Screw Nut	228731	Drip Pan
541197	Feed Driving Connection Hinge Stud Nut	228733	Machine Rest (left)
541197	Feed Lifting Connection Hinge Stud Nut	228734	Machine Rest (right)
541197	Needle Bar Rock Frame Driving Connection Hinge Stud Nut	232365	Foot Lifter Treadle Chain, 41-1/2 inches long
541198	Looper Carrier Crank Clamping Stud Nut	265307	Bed Hinge Connection (2)
541198	Presser Bar Spring Housing Adjusting Nut (2)	268340	Looper Threading Wire
541198	Presser Bar Spring Housing Screw Stud Nut	409813-002	Operator's Guide (U-3426)
541200	Feed Dog Shank Adjusting Screw Lock Nut	409838-002	Parts Chart (U-3471) (for 103 type)
541451	Looper Throw-out Rack Rod Thumb Nut	505656-005	Thread Unwinder complete
541452	Looper Thread Tension Thumb Nut	414583	Wood Screw (for machine rest) (4)
541453	Looper Throw-out Gear Looking Plunger Thumb Nut	415347	Oiler Nozzle and Tube Assembly
543801-012	Looper Throw-out Safety Latch Retaining Ring	543162	Tweezers
543804-004	Foot Lifter Lever Rod Hinge Screw Washer	544381	Bed Hinge Connection Screw (4)
543804-004	Feed Dog Shank Screw Washer	545302	Drip Pan Screw (4)
543804-004	Looper Holder Screw Washer	546923	Oiler (Type "B" 130 cc)
543804-007	Arm Screw Washer (4)	Cat. No. 4112	Needles (62x59) Size 23 (6)
543808-002	Spreader Driving Eccentric Pin		
543841-001	Lifting Rock Shaft Bracket Position Pin (2)	415433	Belt Guard complete

AVAILABLE AT EXTRA CHARGE